



# 10000x

New Edition  
**100%**  
new projects

# EUROPEAN ARCHITECTURE

**BRAUN**





01



02



03



04



05

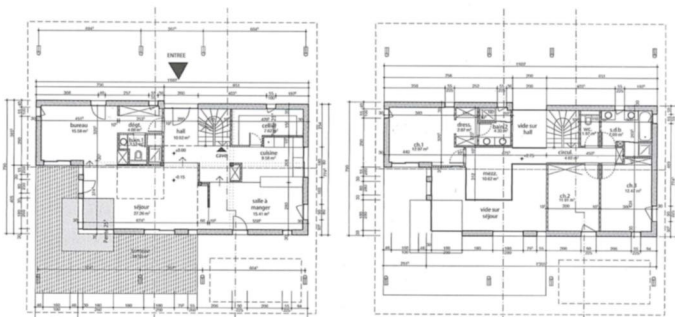

06

## Le Monolithe et la Grange

Built in the Vaud countryside, on the edge of a forest, this home offers a sensitive solution to the client's desire to create a building that shares a dialogue with the surrounding landscape. The design should preserve the spirit of the place and meet the binding regulations of the building authority. The building must care for the environment as well as respect the proposed budget. The project was born from the idea of placing a box-type structure under a traditional barn roof. Larch wood was used for the house while the supporting posts are made of bamboo. Hot water is supplied to the house by energy from solar panels.

01 Entrance | 02 Southwest façade | 03 Northwest façade | 04 Mezzanine | 05 Northwest façade detail | 06 Ground floor and first floor plan